

RD925M

HYDRAULIC ROCK DRILL

TECHNICAL SPECIFICATION

Sandvik RD925M is a hydraulic top hammer rock drill designed for Surface tophammer rigs. It is capable of drilling Ø89 - 127 mm holes up to 29 meters in depth. Optimal hole range is from 89 to 102 mm, using T51 MF-rods.

The RD925M is a heavy-duty hydraulic rock drill designed for medium diameter longhole drilling. The construction of the rock drill is based on three body modules tied together with short side bolts; this ensures minimum number of joint faces and large contact surfaces. The percussion module is simple and reliable in design and consists of only two moving parts – the piston and the distributor sleeve around the piston – all guided by single pilot cylinder, ensuring optimal alignment for parts.

The RD925M is fitted with a drill stabilizer, which is designed to keep the shank adapter in optimal position in relation to the piston; this ensures good rock/bit contact and energy transfer, high penetration rate and rock tool service life.

There are three rotation motor variants to meet the rotation torque and RPM requirements in the RD925M application range. Power extractor (option) can be used for opening rock tool joints manually or automatically when using one-hole automation. The design of the RD925M is covered by several patents.

KEY FEATURES

| | |
|----------------------|--|
| Hole diameter range | 89 – 127* mm (above 102 mm consult factory) |
| Kinetic power | 25 kW |
| Percussion rate | 69 Hz |
| Percussion pressure | Up to 190 bar |
| Rotation pressure | Up to 200 bar (depending rotation motor) |
| Rotation motor types | OMT250 / 315 / 400 |
| Weight | 340 kg |

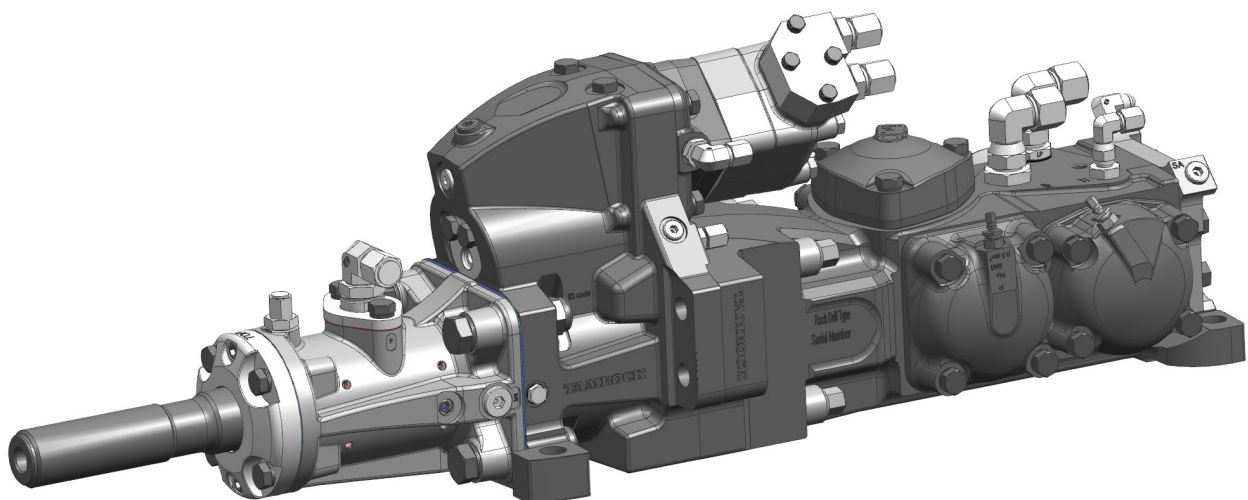

SHANK LUBRICATION

| | Circulating Shank Lubrication (CSL) | Oil Mist Lubrication (SLU) |
|-------------------|-------------------------------------|----------------------------|
| Air flow | 0.5 m³/min | 0.5 m³/min |
| Air pressure | 4 bar | 4 bar |
| Oil consumption | ~1 lpm* | ~700 g/h* |
| Max. oil pressure | 20 bar | |
| Oil type example | Shell Omala 32/100 | Shell air tool oil 32/100 |

* Depends strongly on drilling parameters

ROTATION MOTORS

| Motor | OMT250 | OMT315 | OMT400 |
|-------------------------|-----------|-----------|-----------|
| Pressure max. (dp) | 200 bar | 200 bar | 150 bar |
| Flow (at max speed) | 125 l/min | 125 l/min | 125 l/min |
| Torque at bit | 1 400 Nm | 1 750 Nm | 1 750 Nm |
| Bit rotation speed max. | 250 rpm | 190 rpm | 150 rpm |

SHANK TYPES

With rods T51, bottom contact bearing Ø52 mm and Ø65 mm

ACCUMULATORS

| | |
|--------------------|----------------|
| Accumulator gas | Nitrogen N2 |
| High pressure (HP) | 50 bar (2 pcs) |
| Low pressure (LP) | 4 bar (2 pcs) |
| Stabilizer | 40 bar |
| Filling valve | Vg8 DIN7756 |

OIL RECOMMENDATION

| | |
|---------------------------|--|
| Oil operating temperature | Between 40°C and 60°C |
| Oil recommendation | See Sandvik drill lubricant recommendation |

OPTION

| | |
|--------------------------|----------------------------|
| Power extractor | See separate specification |
| Special tools for RD925M | Field kit or complete set |

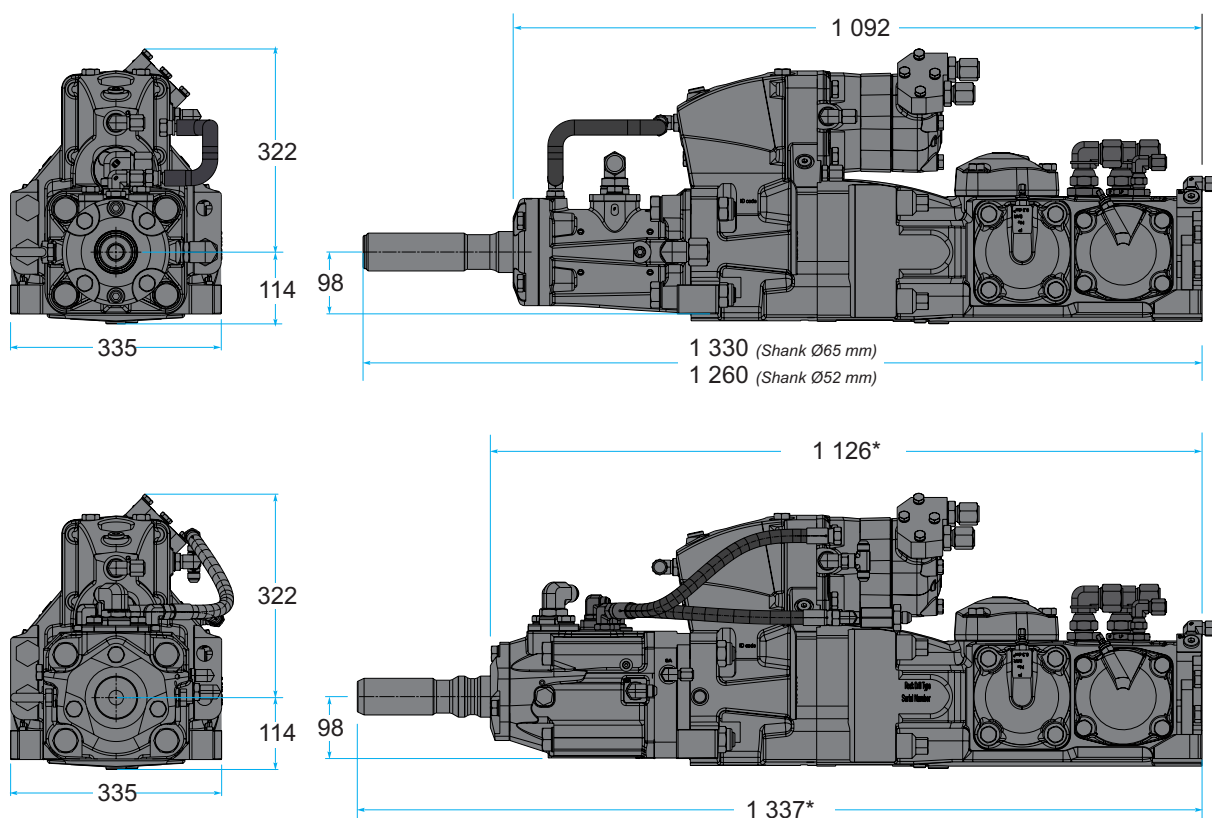

All dimensions in mm
* With power extractor Ø65 mm length
with power extractor Ø52 mm is the same as with flushing head models

Sandvik Mining and Rock Technology reserves the right to make changes to the information on this data sheet without prior notification to users. Please contact a Sandvik representative for clarification on specifications and options.

SANDVIK.COM